



OEM PRODUCTS

REAN® Part Number Guide

RC3FDV-B-0-Z

Packaging:

Without suffix	single bag packaging
-D	industrial bulk packaging (each piece part packed at 100 pcs.)

Retention (female chassis connector only):

w/o number	latch lock
0	retention spring

Plating:

w/o number	nickel plated housing with nickel / silver plated contacts
-B	black plated housing with gold plated contacts
-BAG	black plated housing with nickel / silver plated contacts

Termination:

w/o number	not applicable
H	horizontal PCB mount
V	vertical PCB mount
Y	IDC for wires

Series (if applicable):

S	REAN Silver series
C	Cable Connector
P	Panel- / Chassisconnector (Mini XLR, Loudspeaker)
D	D-size
U	XLR receptacle

Gender / Right angle (if applicable):

F	Female
M	Male
R	Right angle

Number of contacts

Kind of connector:

C	XLR connector female / male
P	Plug
LS	Loudspeaker connector
F	Cinch / Phono / RCA
TP	3.5mm plug
T	Tiny / Mini XLR
J	Jack
M	Module (to be followed by e.g. "T" for Tiny, etc.)
A	Adapter

REAN brand Prefix



TINY xlr Cable Connectors



RT3FC-B



RT4FC-B-W



RT4FCT-B



RT3MC-B

- 3, 4 and 5 pole versions available
- Easy to assemble
- Robust metal housing with best flex relief
- Shielded system – high noise immunity and EMI protection
- Intuitive and rugged locking mechanism provides secure locking system

- Millionfold proven chuck type strain relief
- Keyed insert and strain relief to avoid mispositioning/rotation of insert respectively cable
- Optional sealing boot (patent pending) on RT*FC-B for water/sweat protection if mated with RT*MP
- Optional screw locking design on RT3FCT-B for outstanding ruggedness in mated condition

RT3FC-B

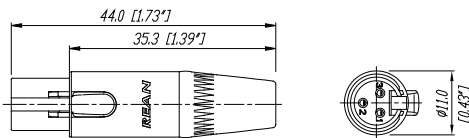

RT3FCT-B

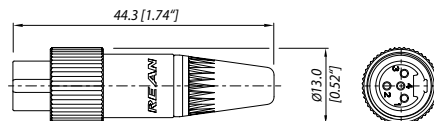

RT3FC-B-W

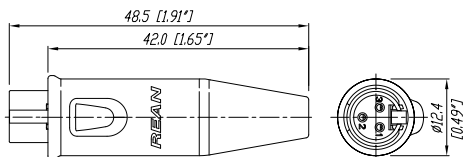

RT3MC-B

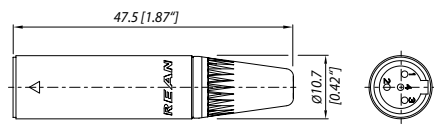

Female Pin-Layouts (front view)

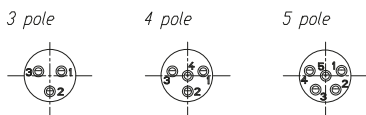

Male Pin-Layouts (front view)

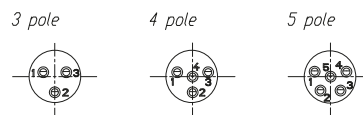

Ordering Information

Type No.		Description
Cable connectors (bulk packed, to be ordered in multiples of 100 pcs.)		
Female	Male	
RT3FC-B-D	RT3MC-B-D	3 pole TINY cable connector, black metal shell, gold plated contacts; industrial bulk packaging available
RT4FC-B-D	RT4MC-B-D	4 pole TINY cable connector, black metal shell, gold plated contacts; industrial bulk packaging available
RT5FC-B-D	RT5MC-B-D	5 pole TINY cable connector, black metal shell, gold plated contacts; industrial bulk packaging available
Cable connectors female water resistant (bulk packed, to be ordered in multiples of 100 pcs.)		
RT3FC-B-W-D		3 pole TINY female cable connector, black metal shell, water resistant boot, gold plated contacts
RT4FC-B-W-D		4 pole TINY female cable connector, black metal shell, water resistant boot, gold plated contacts
RT5FC-B-W-D		5 pole TINY female cable connector, black metal shell, water resistant boot, gold plated contacts
Cable connectors female screw locking (bulk packed, to be ordered in multiples of 100 pcs.)		
RT3FCT-B-D		3 pole TINY female cable connector with screw locking, black metal shell & nut, gold plated contacts
RT4FCT-B-D		4 pole TINY female cable connector with screw locking, black metal shell & nut, gold plated contacts
RT5FCT-B-D		5 pole TINY female cable connector with screw locking, black metal shell & nut, gold plated contacts

Specification

Cable connectors
RT*FC-B*/RT*MC-B*Screw locking
RT*FCT-B*

Electrical		
Rated current per contact	< 5 A	< 5 A
Contact resistance	< 5 mΩ	< 5 mΩ
Insulation resistance	> 1 GΩ	> 1 GΩ
Dielectric strength	> 500 V rms	> 500 V rms
Mechanical		
Lifetime	> 1'000 mating cycles	> 1'000 mating cycles
Cable O.D. range	2.0–4.5 mm	2.0–4.5 mm
Wiring	solder contacts	solder contacts
Max. wire size	0.22 mm ² / 24 AWG	0.22 mm ² /24 AWG
Material		
Bushing	ABS	ABS
Contacts	female CuSn6/male CuZn39Pb3	CuSn6
Contact plating	Au plated	Au plated
Insert	PA 6 30% GR	PA 6 30% GR
Shell (housing)	ZnAl4Cu1	ZnAl4Cu1
Shell plating	black	black
Strain relief	PVC	PVC
Protection boot	EPDM	–
Nut	–	Al, black anodized
Environment		
Operating temperature	-30°C to +85°C	-30°C to +85°C
Solderability	complies with IEC68-2-20	complies with IEC68-2-20



TINY xlr Chassis Connectors



RT3MP



RT4MPR

- Front and rear mountable design in 3, 4 and 5 pole versions available
- Watertight chassis connector, even in unmated condition
- RT*MP provides water resistant connection if mated with RT*FC-B-W

RT*MP

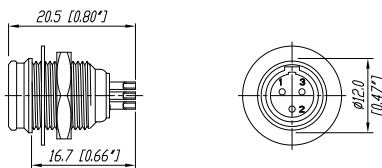

Panel Cutout

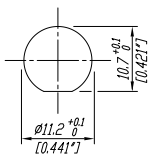

Male Pin-Layouts (front view)

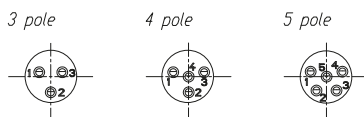

RT4MPR

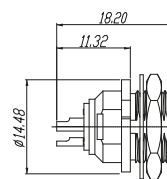

Panel Cutout

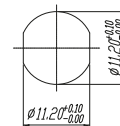

Ordering Information

Type No.	Description
Chassis connectors (bulk packed, to be ordered in multiples of 100 pcs.)	
RT3MP-D	3 pole TINY male chassis connector, nickel metal housing, gold plated contacts, max. panel thickness: 6 mm
RT4MP-D	4 pole TINY male chassis connector, nickel metal housing, gold plated contacts, max. panel thickness: 6 mm
RT5MP-D	5 pole TINY male chassis connector, nickel metal housing, gold plated contacts, max. panel thickness: 6 mm
Chassis connectors rearmountable (bulk packed, to be ordered in multiples of 100 pcs.)	
RT3MPR-D	3 pole TINY rearmountable male chassis connector, nickel metal housing, gold plated contacts, max. panel thickness: 3 mm
RT4MPR-D	4 pole TINY rearmountable male chassis connector, nickel metal housing, gold plated contacts, max. panel thickness: 3 mm
RT5MPR-D	5 pole TINY rearmountable male chassis connector, nickel metal housing, gold plated contacts, max. panel thickness: 3 mm

Specification

Chassis connectors
RT*MP

Electrical

Rated current per contact	< 5 A
Contact resistance	< 5 mΩ
Insulation resistance	> 1 GΩ
Dielectric strength	> 500 V rms

Mechanical

Lifetime	> 1'000 mating cycles
Wiring	solder contacts
Max. wire size	0.22 mm ² / 24 AWG

Material

Contacts	CuZn39Pb3
Contact plating	Au plated
Insert	PA 6 30% GR
Shell (housing)	ZnAl4Cu1
Shell plating	nickel

Environment

Operating temperature	-30°C to +85°C
Solderability	complies with IEC68-2-20

XLR Cable Connectors



XLR Cable Connectors



RC3F-D



RC3F-B-D



RC3M-D



RC3M-B-D

- Attractive design with ergonomic finger groove – valuable and best handling convenience
- Rugged zinc diecast shell – long lasting and reliable
- Chuck type strain relief – best cable retention, easy to assemble

- Rubber boot kink protection – guarantees best cable protection and offers long cable life
- Robust latch locking – provides secure connection

RC*F-D

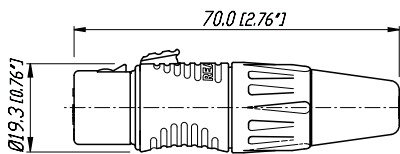

RC*M-D

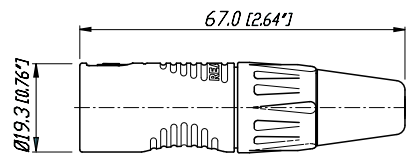

Ordering Information

Type No.	Description
XLR Cable Connectors (bulk packed, to be ordered in multiples of 100 pcs.)	
RC3F-D	3 pole XLR female cable connector, nickel shell, silver plated contacts
RC3F-BAG-D	3 pole XLR female cable connector, black shell, silver plated contacts
RC3F-B-D	3 pole XLR female cable connector, black shell, gold plated contacts
RC3M-D	3 pole XLR male cable connector, nickel shell, silver plated contacts
RC3M-BAG-D	3 pole XLR male cable connector, black shell, silver plated contacts
RC3M-B-D	3 pole XLR male cable connector, black shell, gold plated contacts

Specification

Electrical	
Rated current per contact	10 A
Contact resistance	$\leq 5 \text{ m}\Omega$
Insulation resistance	$> 1.5 \text{ G}\Omega$
Dielectric strength	$> 1 \text{ kV dc}$
Mechanical	
Lifetime	$> 1'000$ mating cycles
Cable O.D. range	4.0–7.0 mm
Wiring	solder contact
Max. wire size	AWG 16 (1.5 mm ²)
Insertion force	$\leq 30 \text{ N}$
Withdrawal force	$\leq 20 \text{ N}$
Material	
Bushing	PA 6 30% GR
Contacts	female CuSn6 / male CuZn39Pb3
Contact plating	Ag or Au
Insert	PA 6 30% GR
Shell (housing)	ZnAl4CU1
Shell plating	Ni or black
Strain relief	POM
Environment	
Operating temperature	-20°C to +70°C
Solderability	complies with IEC68-2-20



U Series



RC3FUH



RC3MUH

- Small design – offers highest packing density
- Tulip type female contacts – lowest contact resistance
- Robust latch locking – provides secure connection
- Selective gold plating – for best conductivity and soldering

RC3FUH1

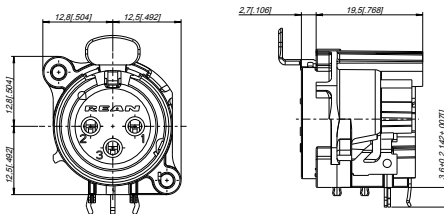

RC3MUH

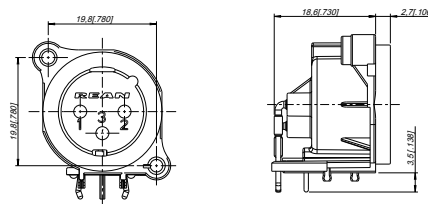

RC3FUV1

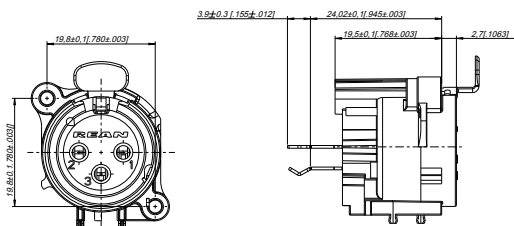

RC3MUV

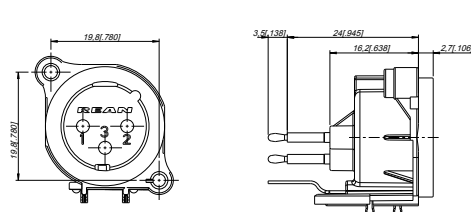

Ordering Information

Type No.	Description
U Series (bulk packed, to be ordered in multiples of 100 pcs.)	
RC3FUH*	3 pole XLR female chassis connector, horizontal PCB mount, available versions on request
RC3FUV*	3 pole XLR female chassis connector, vertical PCB mount, available versions on request
RC3MUH	3 pole XLR male chassis connector, horizontal PCB mount, with latch lock
RC3MUV	3 pole XLR male chassis connector, vertical PCB mount, with latch lock

Specification

Electrical	
Rated current per contact	6 A
Contact resistance	$\leq 6 \text{ m}\Omega$
Insulation resistance	$> 2 \text{ G}\Omega$
Dielectric strength	$> 1.5 \text{ kV dc}$
Mechanical	
Lifetime	$> 1'000$ mating cycles
Insertion force	$\leq 20 \text{ N}$
Withdrawal force	$\leq 20 \text{ N}$
Material	
Insert	PA 6.6 30% GR
Contacts	female CuSn6 / male CuZn35Pb2
Contact plating	gal 0.2 μm AuCo over 2 μm NiP15 (Tribor ®)
Latch lock & spring	Ck 67 steel, treated
Environment	
Operating temperature	-30°C to +80°C
Solderability	complies with IEC68-2-20



IDC D-Shape Chassis



RC3FDY



RC3MDY

- IDC termination suitable for AWG 24 & AWG 26 – offers fast and reliable assembly
- Unified "D" shape – provides compatibility with industry standard
- Front and rear mountable
- Gold plated contacts – for best conductivity

Ordering Information

Type No.	Description
IDC D-Shape Chassis (bulk packed, to be ordered in multiples of 100 pcs.)	
RC3FDY-0	3 pole female chassis connector, D-Shape, IDC termination
RC3MDY	3 pole male chassis connector, D-Shape, IDC termination

Specification

Electrical

Rated current per contact	2 A
Contact resistance	$\leq 5 \text{ m}\Omega$
Insulation resistance	$\geq 1 \text{ G}\Omega$
Dielectric strength	500 V dc

Mechanical

Lifetime	> 1'000 mating cycles
Insertion force	$\leq 20 \text{ N}$
Withdrawal force	$\leq 20 \text{ N}$
Applicable wire size	AWG 24 (0.22mm ²) & AWG 26 (0.14mm ²)

Material

Shell	PA 6.6 30% GR
Contacts	female CuSn6 / male CuZn39Pb3
Contact plating	Au plated
Wire clamp	PA 6.6

Environment

Operating temperature	-25°C to +70°C
-----------------------	----------------

1 / 4 " P l u g s



1/4" Phone Plugs



RP2C-D



RP3C-B-D



RP2RC-BAG-D

- Attractive and valuable design
- Slim 1/4" plug with ergonomic finger groove – grants high packing density along with best handling convenience
- Rugged zinc diecast shell – long lasting and reliable
- Chuck type strain relief – best cable retention, easy to assemble
- Rubber boot kink protection – guarantees best cable protection and offers long cable life
- Compact and ergonomic right angle plug – high packing density

RP2C-D

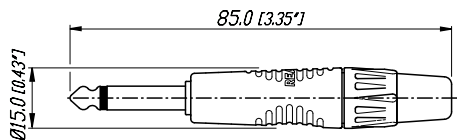

RP3RC-D

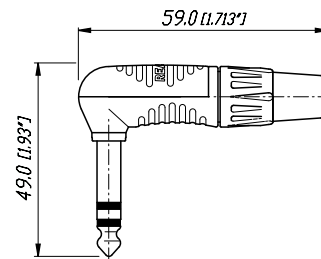

Ordering Information

Type No.	Description
1/4 " Phone Plugs (bulk packed, to be ordered in multiples of 100 pcs.)	
RP2C-D	1/4" plug, 2 pole, nickel shell, nickel plated contacts
RP2C-BAG-D	1/4" plug, 2 pole, black shell, nickel plated contacts
RP2C-B-D	1/4" plug, 2 pole, black shell, gold plated contacts
RP3C-D	1/4" plug, 3 pole, nickel shell, nickel plated contacts
RP3C-BAG-D	1/4" plug, 3 pole, black shell, nickel plated contacts
RP3C-B-D	1/4" plug, 3 pole, black shell, gold plated contacts
RP2RC-D	1/4" plug, 2 pole, right angle, nickel shell, nickel plated contacts
RP2RC-BAG-D	1/4" plug, 2 pole, right angle, black shell, nickel plated contacts
RP2RC-B-D	1/4" plug, 2 pole, right angle, black shell, gold plated contacts
RP3RC-D	1/4" plug, 3 pole, right angle, nickel shell, nickel plated contacts
RP3RC-BAG-D	1/4" plug, 3 pole, right angle, black shell, nickel plated contacts
RP3RC-B-D	1/4" plug, 3 pole, right angle, black shell, gold plated contacts

Specification

Electrical	
Rated current per contact	depends on mating connector
Contact resistance	depends on mating connector
Insulation resistance	> 1.5 GΩ
Dielectric strength	1 kV dc
Mechanical	
Lifetime	> 1'000 mating cycles
Cable O.D. range	4.0–7.0 mm
Wiring	solder contact
Max. wire size	AWG 18 (1 mm ²)
Material	
Bushing	PA 6 30% GR
Contacts	Brass (CuZn39Pb3)
Contact plating	Ni or Au
Insert	PA 6 30% GR
Shell (housing)	ZnAl4Cu1
Shell plating	Ni or black
Strain relief	POM
Environment	
Operating temperature	-20°C to +70°C
Solderability	complies with IEC68-2-20

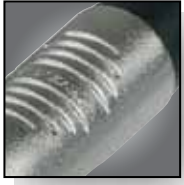

Phono ("RCA/Cinch")



RF2C-AU-O-D



RF2C-B-2-D

- Attractive and slim design with ergonomic finger groove – space saving and convenient to handle
- Rugged zinc diecast shell – long lasting and reliable
- Chuck type strain relief – best cable retention, easy to assemble
- Gold plated contacts – for best conductivity and durability
- Rubber boot kink protection – guarantees best cable protection and offers long cable life

RF2C-*

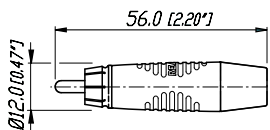

Ordering Information

Type. No.	Description
Phono Plugs (bulk packed, to be ordered in multiples of 100 pcs.)	
RF2C-AU-0-D	RCA plug, nickel shell, gold plated contacts, black boot
RF2C-AU-2-D	RCA plug, nickel shell, gold plated contacts, red boot
RF2C-B-0-D	RCA plug, black shell, gold plated contacts, black boot
RF2C-B-2-D	RCA plug, black shell, gold plated contacts, red boot

Specification

Electrical	
Rated current	depends on mating connector
Contact resistance	depends on mating connector
Insulation resistance	$\geq 1 \text{ G}\Omega$
Dielectric strength	1 kV dc
Mechanical	
Lifetime	> 1'000 mating cycles
Insertion / withdrawal force	$\leq 20 \text{ N} / \geq 10 \text{ N}$
Cable O.D.	4.0–6.0 mm
Material	
Contacts	Brass (CuZn39Pb3)
Contact plating	AU
Insert	PA 6 30% GR
Shell (housing)	ZnAl4Cu1
Shell (plating)	Ni or black
Strain relief	PA 6
Environment	
Operating temperature	-20°C to +70°C
Solderability	complies with IEC68-2-20

3 . 5 m m P l u g s



3 . 5 m m P l u g s



RTP3C-D



RTP3C-B-D

- Valuable and slim design with ergonomic finger groove – space saving and handy
- Rugged all metal housing – reliable and robust
- Heavy duty cable clamp – best strain relief
- Available as 2 pole & 3 pole version

RTP2C-D

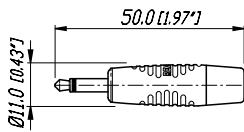

RTP3C-D

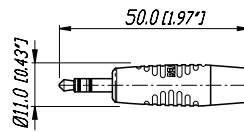

3 . 5 m m P l u g s

Ordering Information

Type No.	Description
3.5 mm Plugs (bulk packed, to be ordered in multiples of 100 pcs.)	
RTP2C-D	3.5 mm plug, 2 pole, nickel shell, nickel plated contacts
RTP2C-BAG-D	3.5 mm plug, 2 pole, black shell, nickel plated contacts
RTP2C-B-D	3.5 mm plug, 2 pole, black shell, gold plated contacts
RTP3C-D	3.5 mm plug, 3 pole, nickel shell, nickel plated contacts
RTP3C-BAG-D	3.5 mm plug, 3 pole, black shell, nickel plated contacts
RTP3C-B-D	3.5 mm plug, 3 pole, black shell, gold plated contacts

Specification

Electrical	
Rated current per contact	depends on mating connector
Contact resistance	depends on mating connector
Insulation resistance	> 1.5 GΩ
Dielectric strength	1 kV dc
Mechanical	
Lifetime	> 1'000 mating mating cycles
Cable O.D. range	2.0–4.0 mm
Wiring	solder contact
Material	
Contacts	Brass (CuZn39Pb3)
Contact plating	Ag or Au
Shell (housing)	ZnAl4Cu1
Shell plating	Ni or black
Strain relief	POM
Environment	
Operating temperature	-20°C to +70°C
Solderability	complies with IEC68-2-20

Loudspeaker Connectors



REAN Loudspeaker Connectors



RLS4FC



RLS4MP

- Glass reinforced materials – rugged connector housing and insert
- Rugged keyway – for reliable mating
- Robust twist lock system – provides secure locking
- Chuck type strain relief – best cable retention, easy to assemble
- Airtight receptacle – “state of the art” for speaker applications

RLS4FC

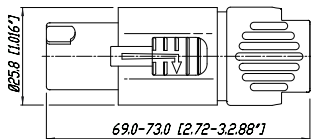

RLS4MP

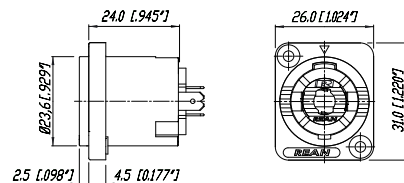

L o u d s p e a k e r C o n n e c t o r s

Ordering Information

Type No.	Description
Cable Connector (bulk packed, to be ordered in multiples of 100 pcs.)	
RLS4FC-D	4 pole cable connector with latch lock, chuck and bushing
Chassis Connector (bulk packed, to be ordered in multiples of 100 pcs.)	
RLS4MP-D	4 pole chassis connector, black D-size housing, flat taps

Specification

	Cable connector RLS4FC	Chassis connector RLS4MP
Electrical		
Rated current per contact	30 A rms continuous	30 A rms continuous
Contact resistance (after lifetime)	$\leq 5 \text{ m}\Omega$	$\leq 5 \text{ m}\Omega$
Insulation resistance (after dampheat)	$> 1 \text{ G}\Omega$	$> 1 \text{ G}\Omega$
Dielectric strength (peak)	4 kVdc	4 kVdc
Rated voltage (Insulation)	250 V	250 V
Attention	Shall NOT be used as an AC mains connector!	Shall NOT be used as an AC mains connector!
Mechanical		
Lifetime	$> 1'000$ mating cycles	$> 1'000$ mating cycles
Cable O.D. range	5–10 mm	–
Wiring	screw type terminals or soldering wire size 12 AWG; 4mm ²	flat tabs for 3/16" (FASTON® 4.8 x 0.5 mm) or soldering
Locking device	Quick Lock	Quick Lock
Mounting location	–	front & rear
Chassis shape	–	D
Material		
Bushing	PA 6 30% GR	–
Contacts	Brass (CuZn39Pb3)	CuSn6
Contact plating	4 μm AG	4 μm AG
Insert	PBTP 20% GR	–
Locking latch	ZnAl4Cu1	–
Shell	PA 6 30% GR	PA 6 30% GR
Strain relief	POM	–
Environment		
Approvals	UL, CSA	–
Flammability	UL 94 HB	UL 94 HB
Solderability	complies with IEC68-2-20	complies with IEC68-2-20
Operating temperature	-30°C to +80°C	-30°C to +80°C